

134

North Pickernell Creek Timber and Recreation Tract Pacific County, Washington

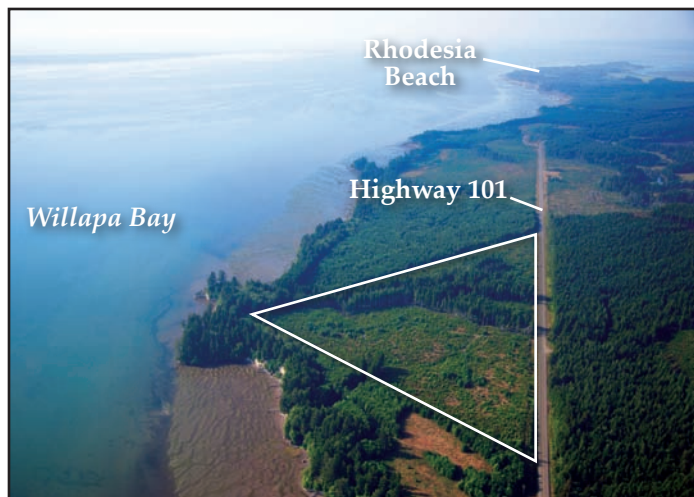

LOCATION: From South Bend, follow US Highway 101 towards Long Beach along Willapa Bay approximately 15 miles to the property.

Township 12 North, Range 10 West, Section 3, Tax Lot 12100360000.

PUBLISHED RESERVE: \$87,000

LAST ASKING: First Time Offered

SIZE: 62.59± Acres

ELEVATION: 56± Feet

ZONING: Transitional Forest

PROPERTY INSPECTION: At Any Time

FINANCING: None – All Cash

DESCRIPTION: The 62.59± acre North Pickernell Creek Timber and Recreation Tract is located in south Pacific County along US Highway 101, approximately three miles south of Bay Center Junction. Auction Properties #135 and #136 are just south of this property. The tract has approximately 3,500 feet of highway frontage. The property was logged 6± years ago and was replanted with hemlock. Some older timber remains in a wet drainage area in the center of the parcel. Transitional forest designation allows one single family residence for each lot of record.

SEALED BIDS DUE NO LATER THAN 5:00 P.M., November 14, 2012

135

North Nemah Road Timber and Recreation Tract Pacific County, Washington

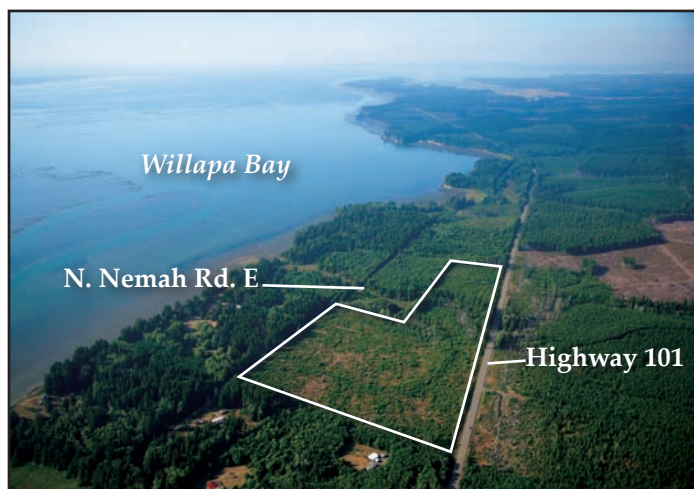

SEALED BIDS DUE NO LATER THAN 5:00 P.M., November 14, 2012

PUBLISHED RESERVE: \$79,500

LAST ASKING: First Time Offered

SIZE: 56.49± Acres

ELEVATION: 57± Feet

ZONING: Transitional Forest

PROPERTY INSPECTION: At Any Time

FINANCING: None – All Cash

DESCRIPTION: This 56.49± acre timber and recreation tract is located in south Pacific County, just two± miles south of Auction Property #134. The property has 2,500± feet of frontage along US Highway 101 on its east boundary and 1,200± feet of frontage along North Nemah Road on its west boundary. The property was logged 5± years ago and was replanted with hemlock. A creek passes through the northern portion of the property and there is older timber lying on both sides of the drainage. The transitional forest designation allows one single family residence for each lot of record.

LOCATION: The property is located along US Highway 101 approximately two miles south of Auction Property #134.

Township 12 North, Range 10 West, Section 15, Tax Lot 12101518000.