



# FALL 2015 AUCTION

*No Starting Bids and No Hidden Reserves!*



## Twenty-One Timber Tracts with Well-Stocked Douglas-Fir Reproduction and Mature Douglas-Fir, Hemlock, Sitka Spruce, Ponderosa Pine, and Red Alder

### Four to be Sold with No Minimum Bid — to the High Bidder!

#### OREGON

#### #119 and #120



251± acre McKenzie River portfolio with over five million board feet, potential entitlements for six dwellings, boat launch and permitted rock quarry, by Blue River - \$2,842,500

#### #109



156± acres with 15-year-old reproduction and 145± MBF, near Silver Falls State Park, in Marion County - \$495,000

#### #1



3± acres along North Santiam River in Marion County, to be sold with No Minimum Bid

#### #123



604± acre Kurzet Ranch in Coos County with 11,600± MBF, two homes, shop, barn, reservoir and 142± acres of bottomland, with water rights, near Bandon Dunes Golf Resort - \$4,195,000

### ORAL AUCTION NOVEMBER 14, 2015 SEALED BIDS DUE NOVEMBER 18, 2015



*Broker Cooperation Invited*



Call For Free Color Catalog #1504

## 1-800-845-3524

Auction conducted by:

Washington Auction License #96

# REALTY MARKETING/NORTHWEST, Broker

522 SW 5th Avenue, Suite 725 Portland, Oregon 97204



# FALL 2015 AUCTION

*No Starting Bids and No Hidden Reserves!*



## #4 and #5



Two tracts of 45± and 52± acres with 16-year-old reproduction, near Nashville in Lincoln County - #4 - \$137,500 #5 - \$172,500



97± acres with 9- to 17-year-old and 393± MBF, near Junction City in Lane County - \$292,500

## #12



80± acres with 1,760± MBF of primarily Sitka spruce, next to Cape Arago State Park in Coos County - \$475,000

## #13



4± acre tract by Canyonville to be sold with No Minimum Bid

## #104

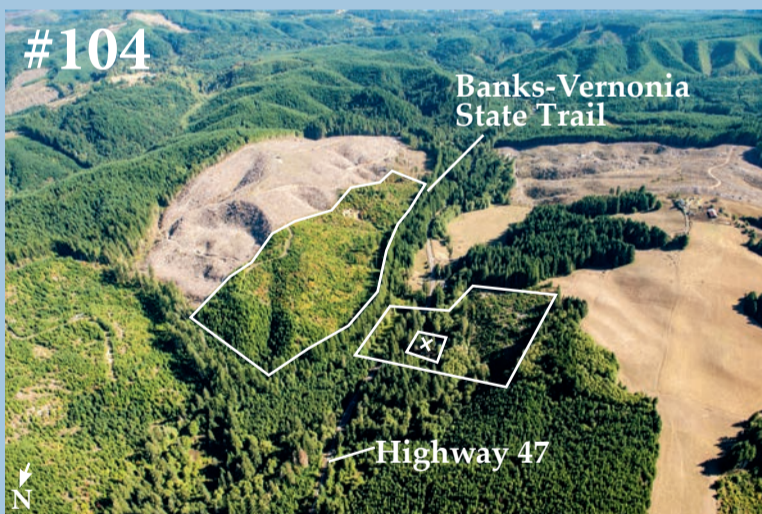

57± acre tract along Highway 47 with 8- and 10-year-old reproduction, in Washington County - \$99,500

## #9



44± acre tract by Dexter Reservoir in Lane County, with 16- and 24-year-old reproduction and two approved home sites - \$138,500

## #14



311± acre Little Red Mountain tract with 462± MBF, in Jackson County - \$95,000

## #124 and #125



1,339± acre Nickel Mountain timber and recreation tract near Riddle. Available in bulk or in three parcels.



# FALL 2015 AUCTION

*No Starting Bids and No Hidden Reserves!*

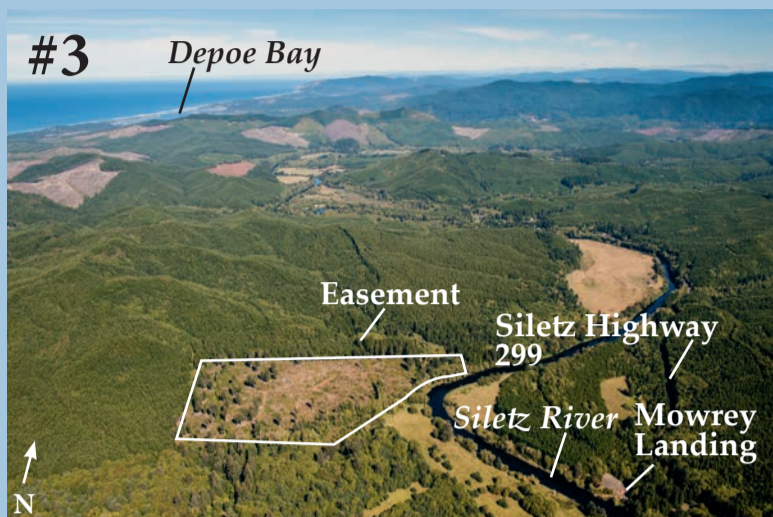

50± acre Siletz River tract with 5-year-old reproduction, in Lincoln County - \$68,500

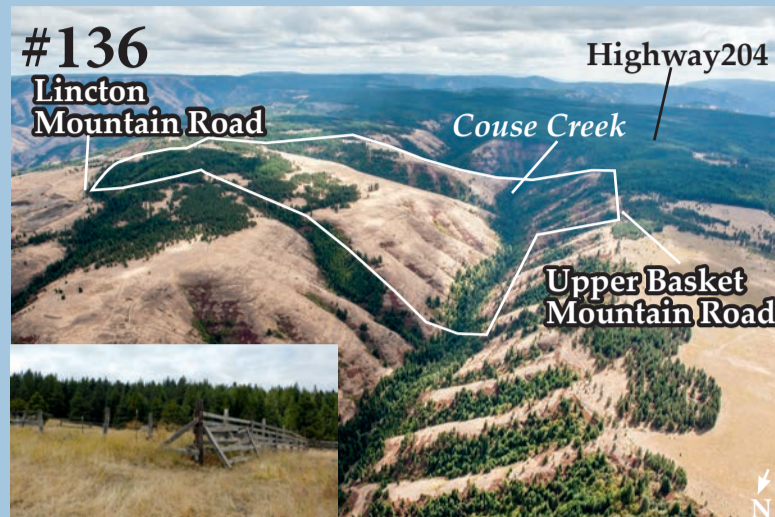

823± acre Linton Mtn. Road elk hunting tract with 225± acres of residual Douglas-fir and pine, near Tollgate in Umatilla County - \$575,000



2± acre tract along Yaquina River by Elk City - boat access only, to be sold with **No Minimum Bid**



160± acre tract with 500± MBF of Douglas-fir and pine, near Riddle

## WASHINGTON



153± acre tract with 23-year-old reproduction and 400± MBF near Bremerton, with Rural Residential Zoning - \$625,000

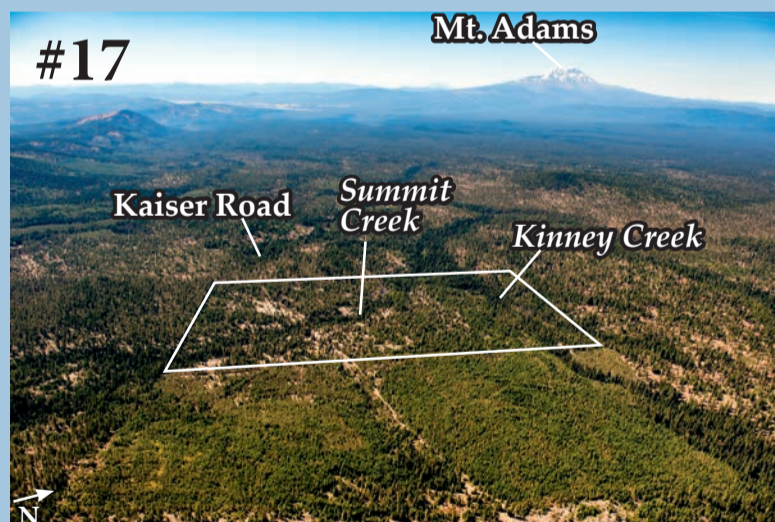

320± acre Summit and Kinney Creeks Tract, within Yakama Indian Reservation, to be sold with **No Minimum Bid**

Call For Free Color Catalog #1504

# 1-800-845-3524

Auction conducted by:

Washington Auction License #96

## REALTY MARKETING/NORTHWEST, Broker

522 SW 5th Avenue, Suite 725 Portland, Oregon 97204



# FALL 2015 AUCTION

*No Starting Bids and No Hidden Reserves!*



## GREENGOLD TABLE OF PROPERTIES

### Oral Auction November 14, 2015

#	Size	Location	Description	Published Reserve
1	3± acres	Marion County, OR	Along North Santiam River across from Idanha, with some residual timber	No Minimum Bid
2	2± acres	Lincoln County, OR	Along Yaquina River by Elk City - boat access only	No Minimum Bid
3	50± acres	Lincoln County, OR	Siletz River frontage, with 42± acres of well-stocked 5-year-old Douglas-fir	\$68,500
4	45± acres	Lincoln County, OR	Well-stocked 16-year-old Douglas-fir reproduction, high site II	\$137,500
5	52± acres	Lincoln County, OR	Well-stocked 16-year-old Douglas-fir reproduction, high site II	\$172,500
6	97± acres	Lane County, OR	9- to 17-year-old Douglas-fir with 393± MBF, near Junction City	\$292,500
9	44± acres	Lane County, OR	16- and 24-year-old Douglas-fir, with approval for two homesites, by Dexter Reservoir	\$138,500
12	80± acres	Coos County, OR	1,760± MBF of 50-year-old spruce, by Cape Arago State Park	\$475,000
13	4± acres	Canyonville, OR	Residual timber	No Minimum Bid
14	311± acres	Jackson County, OR	311± acres within Rogue River-Siskiyou National Forest, with 462± MBF	\$95,000
17	320± acres	Klickitat County, WA	Located within Yakama Indian Reservation, with forest stewardship plan	No Minimum Bid

### Sealed Bid Auction November 18, 2015

#	Size	Location	Description	Published Reserve
104	57± acres	Washington County, OR	8 and 10 year old Douglas-fir reproduction	\$99,500
109	156± acres	Marion County, OR	15 year old well-stocked Douglas-fir with 140± MBF of 45 year old Douglas-fir	\$495,000
119	145± acres	Lane County, OR	McKenzie Riverfront with 3,200± MBF, permitted rock quarry and potential entitlements for three dwellings	\$1,135,000
120	106± acres	Lane County, OR	McKenzie Riverfront with 2,280± MBF, boat launch and potential entitlements for three dwellings	\$1,707,500
123	604± acres	Coos County, OR	11,600± MBF of primarily 50 to 60 year old spruce with some Douglas-fir, red alder and hemlock. Two homes, shop, barn and 142± acres of bottom land with water rights for irrigation, near Bandon Dunes Golf Resort	\$4,195,000
124	199± acres	Douglas County, OR	Residual timber with two small ponds next to Nickel Mine	SOLD
125	980± acres	Douglas County, OR	Residual timber with ridge top west of Riddle	SOLD
126	160± acres	Douglas County, OR	500± MBF of Douglas-fir and pine near Riddle	SOLD
136	823± acres	Umatilla County, OR	Elk hunting and timber tract with an estimated 200± acres of Douglas-fir and pine along Lincton Mtn. Road, near Tollgate	\$575,000
145	153± acres	Kitsap County, WA	80± acres of 23 year old Douglas-fir with 400± MBF and 5 acre zoning near Bremerton	\$625,000

**ORAL AUCTION NOVEMBER 14, 2015**  
**SEALED BIDS DUE NOVEMBER 18, 2015**



*Broker Cooperation Invited*



**Supplemental Information Package with Bid Documents, Maps, Ortho Aerials, Timber Inventory, Preliminary Title Report, and Purchase and Sale Agreement Form are Available for Each Property**

**Call 1-800-845-3524 or Email [info@rm-nw-auctions.com](mailto:info@rm-nw-auctions.com)**

Auction conducted by:

Washington Auction License #96

**REALTY MARKETING/NORTHWEST, Broker**

**522 SW 5th Avenue, Suite 725 Portland, Oregon 97204**